



The Great Lakes - St. Lawrence Seaway System
Le réseau Grands Lacs - Voie maritime du Saint-Laurent

2015 – Notice to Shipping #24

MAISONNEUVE REGION

MONTREAL / LAKE ONTARIO SECTION

Test of new bank lighting in South Shore canal

A bank lighting renewal program from Montreal to Lake St Louis on the northern side of the dike will begin this fall. The project will be starting at the northern extremity of the dike (Montreal Harbor) towards St Lambert lock this winter and will be continuing up to Lake St Louis in subsequent years.

There will be 3 zones of different types of Dell bank lighting installed below lock #2 (Côte St Catherine) at the positions indicated on the attached plan. Each zone will have two new lighting posts.

The operation centre will conduct a survey on the ground lighting installed in each zone.

Please provide the zone of lighting that best meets your needs and notify the operations center if a zone is not suitable for your needs.

Thank you for your cooperation.

Maisonneuve Region
August 20, 2015

The St. Lawrence Seaway Management Corporation
Corporation de Gestion de la Voie Maritime du Saint-Laurent

Région Maisonneuve
151, rue de l'Écluse
St-Lambert, Québec
J4R 2V6

Tél : (450) 672-4115 Fax : (450) 672-8493

Niagara Region
508 Glendale Avenue
P.O. Box 370
St-Catharines, Ontario
L2R 6V8

Tél : (905) 641-1932 Fax : (905) 641-5721

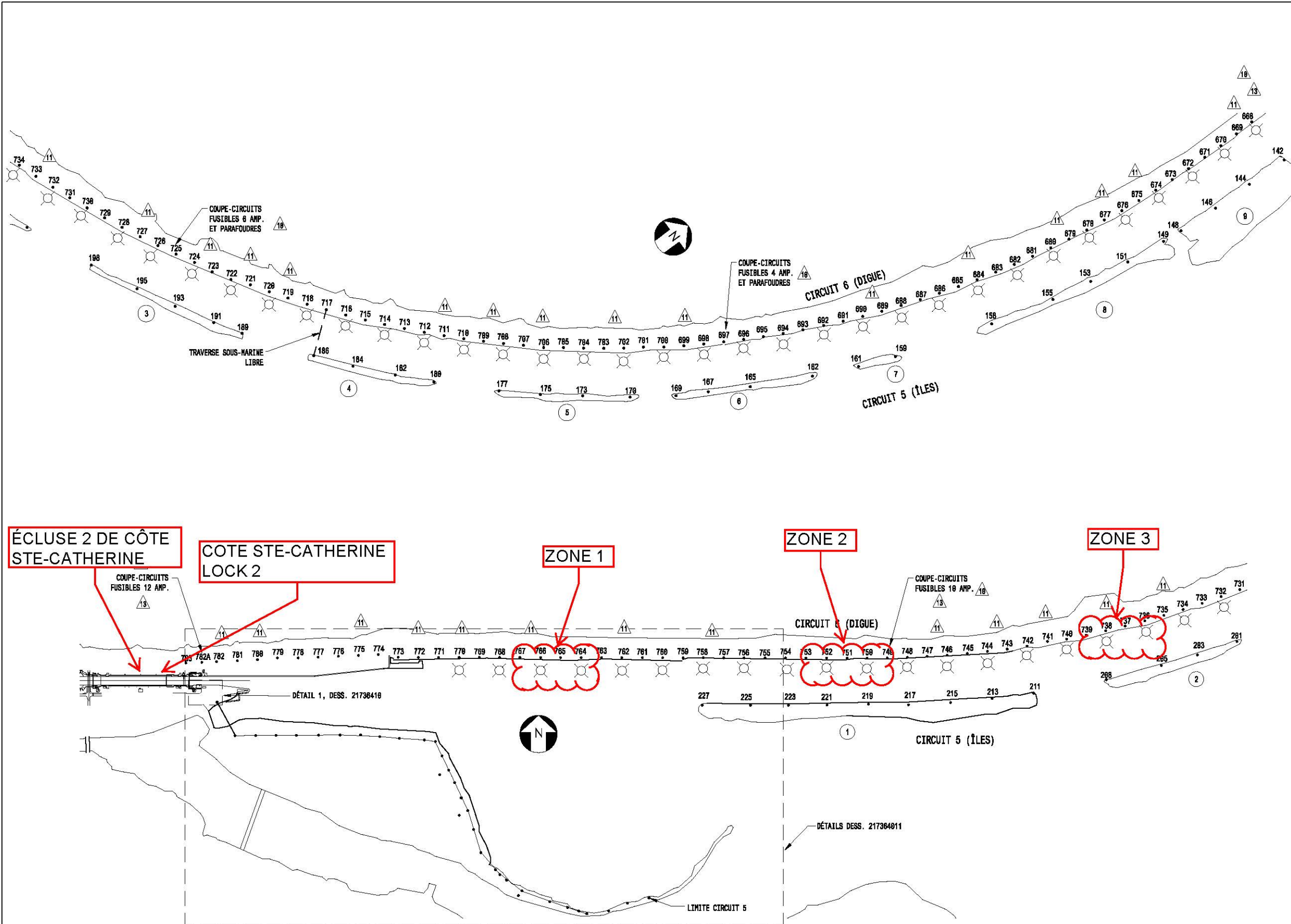

REF.	DESCRIPTION	DESSIN
1		
2		
3		
4		

NOTE:

LÉGENDE:

▲ : BALISE 35W S.H.P.

▲ ▲ : BALISE 35W S.H.P.

NO.	DATE	DESCRIPTION	RÉFÉRENCE	PAR	CON	APP.
13	2014.02.05	TEL QUE CONSTRUIT	M/233-15/021	JFC	SL	SR
12	2013.09.22	ÉNIS POUR CONSTRUCTION	M/233-15/021	AT	SL	SR
11	2013.07.08	ÉNIS POUR COMMENTAIRES ET APPEL D'OFFRES	M/233-15/021	AT	SL	SR
10	2013.03.19	TEL QUE CONSTRUIT	M/233-16/021	AT	SL	DG
09	2011.09.23	ÉNIS POUR CONSTRUCTION	M/233-16/021	AT	RN	

Relevé

Simon Remilleu ing.

2014-02-28

THE ST. LAWRENCE SEAWAY MANAGEMENT CORPORATION



CORPORATION DE GESTION DE LA VOIE MARITIME DU ST-LAURENT

RÉGION MAISONNEUVE
CANAL DE LA RIVE-SUD

BALISAGE DU CANAL
SECTEUR CÔTE STE-CATHERINE, CIRCUITS 5 ET 6
LOCALISATION DES POTEAUX 149 À 227 ET 675 À 783

Conçu	R.F.	Projet Initial	12-2546	Date	1997.05.16
Dessiné	H.R.	Recommandé	R.F.	Échelle	
Vérifié	R.F.	Approuvé	L.R.H.	CONTR. NO	217364001-